

Layout Tab Name: EX1 AIRPORT PROPERTY INVENTORY MAPS, Images: SGH\_OH\_from sid 04 graystyle.tif, Xrefs: 76515-y.dwg, 76515-x.dwg, 76515-P.dwg, 76515 proposed airspace.dwg, SGH Fee\_CCI.dwg, SGH Emmts\_CCI.dwg, SGH SURVEY Points.dwg  
 Last Saved By: Frie, 3/9/2020 7:21:57 AM  
 C:\DC\clients\Springfield-Beckley Municipal Airport OH (SGH)\76515 SGH Master Plan\Add\Exhibit A\76515 Exhibit A.dwg Plotted By: Frie, Gaster Plotted: March 9, 2020, 8:56:47 AM

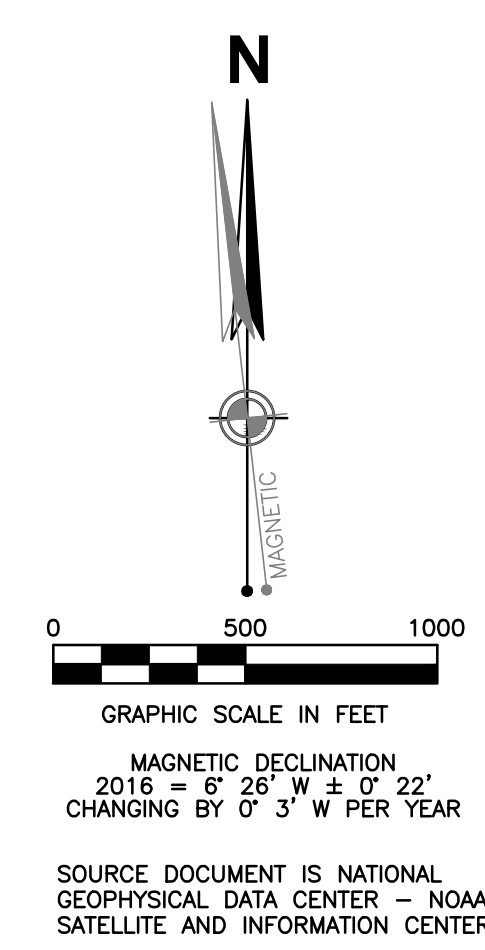
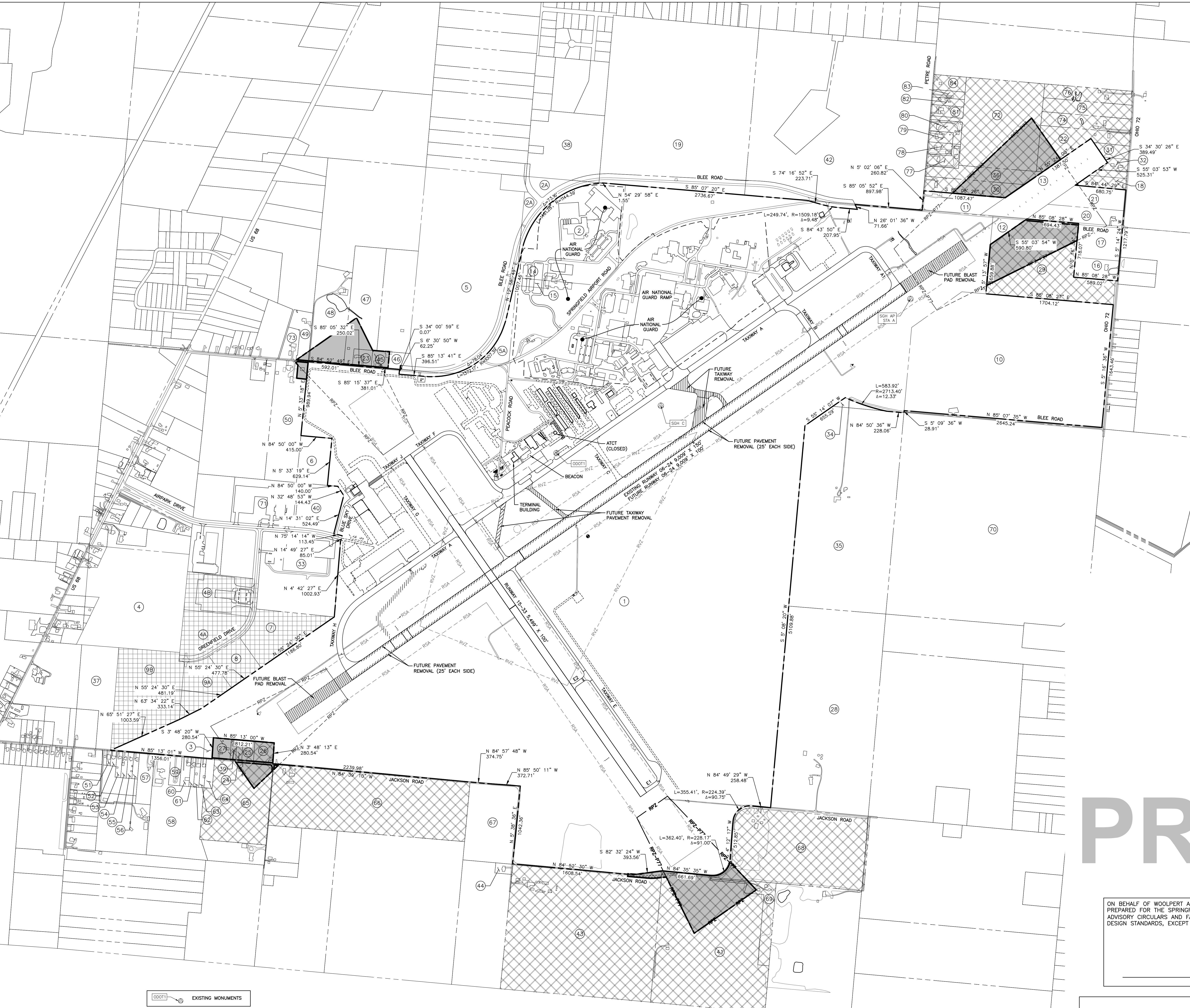

**LEGEND: SYMBOLS**

SYMBOL	DESCRIPTION
(35)	TRACT NUMBER (PROPERTY IDENTIFIER)
[Hatched Box]	PROPOSED PROPERTY ACQUISITION
[Cross-hatched Box]	EXISTING PROPERTY EASEMENTS
[Dotted Box]	FAA LAND RELEASED PROPERTY NOT FEDERALLY OBLIGATED (01-27-09)
[Diagonal Line Box]	FUTURE PAVEMENT REMOVAL

**LEGEND: LINETYPE**

EXISTING	FUTURE	FACILITY
[Solid Line]	[Solid Line]	AIRPORT PROPERTY LINE
[Dashed Line]	[Dashed Line]	PARCEL LINE
[Dotted Line]	[Dotted Line]	PREVIOUS AIRPORT PARCEL LINE
[Dash-dot Line]	[Dash-dot Line]	RUNWAY/TAXIWAY CENTERLINE
[Long Dash Short Dash]	[Long Dash Short Dash]	EDGE OF PAVEMENT
[Short Dash Long Dash]	[Short Dash Long Dash]	RUNWAY VISIBILITY ZONE
[Dash-dot-dot Line]	[Dash-dot-dot Line]	RUNWAY PROTECTION ZONE
[Long Dash Long Dash]	[Long Dash Long Dash]	RUNWAY SAFETY AREA
[Dotted Line]	[Dotted Line]	AIR NATIONAL GUARD BOUNDARY

- EXHIBIT "A" NOTES**
- THE SPRINGFIELD-BECKLEY MUNICIPAL AIRPORT (SGH) IS LOCATED IN THE STATE OF OHIO, CLARK COUNTY, GREENE TOWNSHIP T-4-E, R-9-S-N, SECTIONS 4, 5, 10 AND 11; AND GREENE TOWNSHIP T-4-E, R-9-S-N, SECTIONS 35 AND 36.
  - AIRPORT PROPERTY IS ADMINISTERED BY THE SPRINGFIELD-BECKLEY MUNICIPAL AIRPORT.
  - THE AIRPORT PROPERTY PERIMETER AND PARCEL BOUNDARY MAPPING LINWORK WAS OBTAINED ELECTRONICALLY FROM THE CLARK COUNTY (OHIO) GIS DOWNLOAD PAGE AND ACQUIRED NOVEMBER 2016. THE BASE MAPPING FEATURES ARE DEPICTED FOR ON AND OFF-AIRPORT CONDITIONS AS OF SEPTEMBER, 2016.
  - THE EXISTING PARCEL INFORMATION WAS OBTAINED FROM A REVIEW OF PREVIOUS AIRPORT EXHIBIT "A" AND AIRPORT LAYOUT PLAN (ALP) PROPERTY MAPS, AS VERIFIED THROUGH A REVIEW OF DEED RECORDS CONDUCTED BY CCI AND WOOLPERT.
  - THE EXISTING AND FUTURE AIRPORT PARCEL METES AND BOUNDS HAVE NOT BEEN FIELD SURVEYED AS PART OF THIS EXHIBIT "A" AIRPORT PROPERTY MAP UPDATE. THE PROPERTY TABLE REFLECTS THE PARCEL ACREAGE FROM THE RECORDED DEEDS, OR IF OTHERWISE ABSENT OR INCONSISTENT, HAS BEEN INSERTED BY WOOLPERT AND CCI USING ELECTRONIC AUTOCAD DRAWING FILE. THE ACREAGE FOR FUTURE AIRPORT PROPERTY INTERESTS HAVE BEEN ESTIMATED BY CCI AND WOOLPERT USING ELECTRONIC AUTOCAD DRAWING FILE CALCULATIONS.
  - EXHIBIT "A" REFLECTS THE PLANNED LAND ACQUISITION PROJECT RUNWAY PROTECTION ZONE (RPZ) STANDARDS AND AIRSPACE PROTECTION. REFERENCE THE AIRPORT LAYOUT PLAN (ALP) FOR EXISTING AND FUTURE PROJECT IMPROVEMENTS, INCLUDING LAND ACQUISITION.
  - AIR NATIONAL GUARD LEASED PROPERTY SCHEDULE FROM THE CITY OF SPRINGFIELD SHOWN ON SHEET D-3.
  - SEE ALP DATA SHEET FOR REFERENCE TO SUPPORTING ALP DATA. SEE TERMINAL AREA DRAWINGS FOR BUILDING/STRUCTURE DATA.

**PROPERTY DISCLAIMERS**

THIS DRAWING IS A PLANNING REPRESENTATION DEPICTING THE AIRPORT PROPERTY BOUNDARY INTERESTS, AND IS NOT INTENDED TO BE USED FOR THE PURPOSES OF CONDUCTING OR SATISFYING RECORDED SURVEY OR APPRAISAL REQUIREMENTS. FUTURE AIRPORT LAND INTERESTS ARE SUBJECT TO SURVEY, PROPERTY AND RIGHT-OF-WAY RESEARCH, APPRAISAL, AND OTHER POSSIBLE FACTORS REQUIRED UNDER FEDERAL GUIDANCE.

THE SALE, TRANSFER OR LONG TERM LEASE (45 YEARS) FOR ANY AIRPORT PROPERTY FOR NON-AERONAUTICAL PURPOSES IS PROHIBITED WITHOUT PRIOR WRITTEN FAA APPROVAL. FUTURE LAND ACQUISITION INVOLVING FEDERAL OR STATE ASSISTANCE MUST HAVE PRIOR ENVIRONMENTAL CLEARANCE AND AGENCY APPROVAL.

# PRELIM

ON BEHALF OF WOOLPERT AND CCI, THIS PROPERTY INVENTORY MAP/EXHIBIT "A" WAS PREPARED FOR THE SPRINGFIELD-BECKLEY MUNICIPAL AIRPORT ACCORDING TO THE APPLICABLE ADVISORY CIRCULARS AND FAA CHECKLIST (ARP SOP No. 300). THIS CONFORMS WITH FAA DESIGN STANDARDS, EXCEPT AS NOTED.

PREPARER \_\_\_\_\_

DATE APPROVED \_\_\_\_\_

ASSISTANT CITY MANAGER \_\_\_\_\_ AIRPORT MANAGER \_\_\_\_\_

CITY OF SPRINGFIELD, OHIO  
 SPRINGFIELD-BECKLEY MUNICIPAL AIRPORT  
 APPROVED AND ADOPTED

**PROJECT CONTROL COORDINATES (US Survey Feet)**

PID	Name	Latitude	Longitude	Northing	Eastng	Elevation	Description	Displayed on Sheet
AB6051	ODOT 1	39°50'35.93638"	83°50'30.16409"	674175.874	1591770.056	1042.321	PACS / CBN	YES
AB3441	SGH AP STA A	39°50'56.91393"	83°49'30.08234"	676229.056	1596486.955	1033.331	SACS	YES
JY1156	H 34	39°53'41.34556"	83°36'17.08096"	692033.830	1658532.349	1178.075	CBN	NO
JZ0128	PAT AZ MK	39°48'01.54352"	84°03'57.34195"	659569.748	1528548.960	800.376	CBN	NO
JZ3680	U 346	39°56'55.90513"	84°11'19.86440"	714252.423	1495028.590	904.726	BM	NO
AB3443	SGH C	39°50'42.37814"	83°50'12.44653"	674807.114	1593161.489	1048.226	BM	YES

**RUNWAY COORDINATES/SURVEY INFORMATION**

Point	Northing	Eastng	Elevation	LATITUDE	LONGITUDE
EOR 06	671211.848	1589006.942	1051.3	39°50'06.23915"	83°51'05.01680"
EOR 24	676374.840	1596390.066	1036.9	39°50'58.34050"	83°49'31.35194"
EOR 15	674130.919	1589780.077	1042.1	39°50'35.19917"	83°50'55.66579"
EOR 33	669625.095	1592390.443	1041.3	39°49'51.13635"	83°50'14.42453"

CERTIFIED BY: \_\_\_\_\_ DESIGN ENGINEER DATE \_\_\_\_\_  
 DESIGNED BY: GCF DRAWN BY: RLS  
 CHECKED BY: M.M. APPROVED BY: CJS

**FINAL DRAFT**

333 North Alabama Street  
 Suite 200  
 Indianapolis, IN 46204  
 317.299.7500  
 FAX: 317.291.5605

**WOOLPERT**  
 ARCHITECTURAL ENGINEERING

REVISION	DATE	DESCRIPTION
No.		

PROJECT No: 076515  
 DATE: 03-09-2020  
 AIP No: 3-39-0072-024-2016  
 HORIZ. SCALE: 1" = 500'  
 VERT. SCALE: \_\_\_\_\_  
 SHEET NO.

**EX1**

AIRPORT LAYOUT PLAN  
 AIRPORT PROPERTY INVENTORY MAPS  
 EXHIBIT "A"  
 SPRINGFIELD-BECKLEY MUNICIPAL AIRPORT SPRINGFIELD, OHIO

Layout Tab Name: EX2 AIRPORT PROPERTY INVENTORY MAPS; Images: SGH\_OH\_from sid 04; gray-scale.tif; Xrefs: 76515-X.dwg; 76515-TBLK.dwg; SGH\_PARCEL\_LINES\_CCI.dwg; SGH\_Parcels.dwg; SGH\_Fee\_CCI.dwg; SGH\_Easmts\_CCI.dwg; SGH\_SURVEY\_Points.dwg; Last Saved By: Ffrie, 3/9/2020 7:21:15 AM; C:\DC\clients\Springfield-Beckley Municipal Airport OH (SGH)\76515 SGH Master Plan\Cadd\Exhibit A\76515 Exhibit A.dwg Plotted By: Ffrie, Gaster Plotted: March 9, 2020, 7:21:29 AM

SPRINGFIELD BECKLEY MUNICIPAL AIRPORT (SGH) LAND INTEREST TABLE											
TRACT #	PREVIOUS MAP ID#	PARCEL #	ACRES	OWNER	SELLER	ACQUISITION TYPE	NOTES AND PROJECT TYPE	INSTRUMENT	RECORDER LIBER	TRANSFER DATE	ADDRESS/DESCRIPTION
1	NA	100-11-00005-000-013	1197.45	City of Springfield Ohio	NA	Fee Simple	Acquire Airport Pre 5-13-1946	NA	NA	NA	
FS-1				City of Springfield Ohio	Harold D. Hawk and Eula Allen Hawk	Fee Simple	Warranty	Book 449 / Page 237		3/6/1954	
FS-2				City of Springfield Ohio	D&L Gerhardt	Fee Simple	See Tract 4, 7, 8, 9	Co-Executors Deed	Book 492-519	6/22/1958	
FS-3				City of Springfield Ohio	O.H. & W.C. McGlore	Fee Simple	Warranty	Book 535-558		3/15/1963	
FS-4				City of Springfield Ohio	W & E. Click	Fee Simple	Warranty	Book 541-46		8/27/1963	
FS-5				City of Springfield Ohio	Indiana Order of Odd Fellows	Fee Simple	Warranty	Book 560-99		1/25/1965	
FS-6				City of Springfield Ohio	Nancy Ellen Saks	Fee Simple	Acquire Airport	Warranty	Book 1761 / Page 2573	2/1/2006	5104 Peacock Road
2	2	100-11-00005-000-001	32.13	City of Springfield Ohio	Nancy Ellen Saks	Fee Simple	Acquire Airport	Warranty	Book 1761 / Page 2573	2/1/2006	5104 Peacock Road
2a	2	100-11-00005-000-001	2.72	City of Springfield Ohio	Nancy Ellen Saks	Fee Simple	Not Federally Obligated (Off Airport Property)	Warranty	Book 1761 / Page 2573	2/1/2006	5104 Peacock Road
3	NA	100-11-00010-000-012	0.67	City of Springfield Ohio	Anna Mae Hopkins	Fee Simple	Acquire Airport	Warranty	Book 1915 / Page 1931	10/26/2010	2160 West Jackson Rd
4	NA	100-11-00010-000-033	38.07	City of Springfield Ohio	Joyce A and Philip R Lind	Fee Simple	Not Federally Obligated (Off Airport Property)	General Warranty	Book 1860 / Page 1941	10/24/2008	
4a	FS-3	100-11-00010-000-033	8.35	City of Springfield Ohio	Joyce A and Philip R Lind	Fee Simple	FAA Land Released with Restrictions on January 27, 2009 (Part of 69.525 Acres)	General Warranty	Book 1860 / Page 1941	10/24/2008	
4b	FS-3	100-11-00011-303-004	10.22	Bob Evans Transportation Company, LLC	City of Springfield Ohio	Fee Simple	FAA Land Released with Restrictions on January 27, 2009 (Part of 69.525 Acres)				8111 Smiths Mill Rd.
5	1	100-11-00011-000-005	69.28	City of Springfield Ohio	Nancy Ellen Saks	Fee Simple	Not Federally Obligated (Off Airport Property)	Warranty	Book 1761 / Page 2573	2/1/2006	5232 Peacock Road
5a	1	100-11-00011-000-005	4.35	City of Springfield Ohio	Nancy Ellen Saks	Fee Simple	Acquire Airport	Warranty	Book 1761 / Page 2573	2/1/2006	5232 Peacock Road
6	FS-3	100-11-00011-302-006 (formerly part of 100-11-00011-301-034)	5.98	City of Springfield Ohio	Bob Evans Farms Inc., City of Springfield Ohio, Kuss R L Trustee, Meva Formwork Systems Inc.	Fee Simple	Airpark Detention Pond; Not Federally Obligated (Off Airport Property)	Plat	Book 18 / Page 260	9/15/2009	
7	FS-3	100-11-00011-304-002 (formerly part of 100-11-00005-000-013)	11.35	City of Springfield Ohio	Harold D. Hawk and Eula Allen Hawk	Fee Simple	FAA Land Released with Restrictions on January 27, 2009 (Part of 69.525 Acres)	Plat	Book 18 / Page 303	1/10/2012	6137 Green Field Drive
8	FS-3	100-11-00011-304-003 (formerly part of 100-11-00005-000-013)	5.48	City of Springfield Ohio	Harold D. Hawk and Eula Allen Hawk	Fee Simple	FAA Land Released with Restrictions on January 27, 2009 (Part of 69.525 Acres)	Plat	Book 18 / Page 303	1/10/2012	6183 Green Field Drive
9a	FS-3	100-11-00011-304-004 (formerly part of 100-11-00005-000-013)	7.75	City of Springfield Ohio	Harold D. Hawk and Eula Allen Hawk	Fee Simple	FAA Land Released with Restrictions on January 27, 2009 (Part of 69.525 Acres)	Plat	Book 18 / Page 303	1/10/2012	6215 Green Field Drive
9b	FS-3	100-11-00011-304-004 (formerly part of 100-11-00005-000-013)	22.73	City of Springfield Ohio	Harold D. Hawk and Eula Allen Hawk	Fee Simple	FAA Land Released with Restrictions on January 27, 2009 (Part of 69.525 Acres)	Plat	Book 18 / Page 303	1/10/2012	6215 Green Field Drive
10	FS-11	100-12-00035-000-037	94.61	City of Springfield Ohio	Springfield Clark Co Joint Vocational School District	Fee Simple	Acquire Airport	Warranty	Book 1728 / Page 2056	6/10/2005	Springfield-Jamestown Road
11	AE-H	100-12-00036-000-055	5.04	City of Springfield Ohio	Joshua U. Zentz	Fee Simple	Acquire Airport	Warranty	Book 1895 / Page 2441	2/2/2010	300 W Sparrow Rd
12	FS-8	100-12-00035-000-1033	1.71	City of Springfield Ohio	Paul and Carol Clark	Fee Simple	Acquire Airport	Eminent Domain/Fee Simple	Book 793 / page 642	12/27/1983	
13	FS-7	100-12-00036-000-1030	14.25	City of Springfield Ohio	Paul and Carol Clark	Fee Simple	Acquire Airport	Eminent Domain/Fee Simple	Book 794 / Page 588	12/27/1983	
14	2	100-11-00005-000-002	2.08	City of Springfield Ohio	Nancy Ellen Saks (seller)	Fee Simple	Acquire Airport	Warranty	Book 1761 / Page 2573	2/1/2006	5200 Peacock Rd. Parcel 1-WDV-1 in SGH Land Release pdf
15	FS-10	100-11-00005-000-003	1.05	City of Springfield Ohio	Deed papers say Kenneth D Bolin & Toni S. Bolin. (County Auditor sayd Glenn R. & Darla J. Vose)	Fee Simple	Acquire Airport	Warranty	Book 1693 / Page 3382	9/15/2004	5250 Peacock Rd
16	AE-G	100-12-00035-000-027	3.60	City of Springfield Ohio	Roger M. & Mary A Pierce	Fee Simple	Acquire Airport	Warranty	Book 1900 / Book 2045	4/20/2010	5119 Springfield-Jamestown Rd
17	AE-G	100-12-00035-000-028	6.14	City of Springfield Ohio	Mary A. Pierce	Fee Simple	Acquire Airport	Warranty	Book 1900 / Book 2045	4/20/2010	5119 Springfield-Jamestown Rd
18	AE-H	100-12-00036-000-069	1.87	Hufford, Michael K & Sherri L	NA	Easement	Survivorship	Book 1125/ Page 1114		8/24/2010	4913 Springfield-Jamestown Rd
19	N/A	100-11-00006-301-022	92.64	Hays John C Trustee	Hays John C		Quit Claim	Book 1504/ Page 2207		11/28/2001	Sparrow Rd
20	AE-H	100-12-00036-000-049	5.57	City of Springfield Ohio	Rosalie A Vail	Easement	Warranty	Book 1831 / Page 289		10/9/2007	NW corner of Sparrow Rd & Springfield-Jamestown Rd
21	AE-H	100-12-00036-000-050	5.21	City of Springfield Ohio	Rosalie A Vail	Easement	Warranty	Book 1831 / Page 290		10/9/2007	Springfield-Jamestown Rd
22	AE-H	100-12-00036-000-051	8.28	Clouse Patrick K	Julie L Clouse	Existing Easement; Future Simple Fee	Quit Claim	Book 1841 / Page 1934		2/14/2008	4767 Springfield-Jamestown Rd
23	N/A	100-11-00011-000-010	1.29	Folk Cathy S	Stuart E Folk	Future Fee Simple	Future RPZ Land Clearing	Certificate of Transfer (inheritance)	Book 2106 / Page 1046	1/18/2017	1870 W BLEE RD; SPRINGFIELD 45502
24	AE-F	100-11-00010-000-016	0.5	Garrey Charles W	Ellen G Svendsen	Existing Easement; Future Simple Fee	Future RPZ Land Clearing	Quit Claim	Book 439 / Page 112	9/29/1995	JACKSON RD; SPRINGFIELD 45502
25	AE-F	100-11-00010-000-017	1	Garrey Charles W	Ellen G Svendsen	Existing Easement; Future Simple Fee	Future RPZ Land Clearing	Quit Claim	Book 439 / Page 112	9/29/1995	JACKSON RD; YELLOW SPRINGS 45387
26	AE-F	100-11-00010-000-018	1.75	Garrey Charles W	Ellen G Svendsen	Existing Easement; Future Simple Fee	Future RPZ Land Clearing	Quit Claim	Book 439 / Page 112	9/29/1995	2010 W JACKSON RD; YELLOW SPRINGS 45387
27	FS-3	100-11-00010-000-032	1.47	Gregory William D	Gregory William D & Monica J Fraley	Existing Easement; Future Simple Fee	Future RPZ Land Clearing	Quit Claim	Book 1806 / Page 1741	2/15/2007	2138 W JACKSON RD; YELLOW SPRINGS 45387
28	N/A	100-11-00004-000-003	8.2	Hays John C Trustee	John C Hays		Quit Claim	Book 1504 / Page 2207		11/27/2001	364 W JACKSON RD; SPRINGFIELD 45502
29	AE-I	100-12-00035-000-032	29.85	Hensley Pauline	Ray C & Pauline Hensley	Existing Easement; Future Simple Fee	Future RPZ Land Clearing	Certificate of Transfer (inheritance)	Book 878 / Page 980	1/27/1992	Springfield-Jamestown Rd
30	AE-H	100-12-00036-000-056	5.45	Herzog Lori M & Jason L	Lori Herzog	Existing Easement; Future Simple Fee	Future RPZ Land Clearing	Quit Claim	Book 2069 / Page 1012	10/28/2015	332 W SPARROW RD; SPRINGFIELD 45502
31	AE-H	100-12-00036-000-068	1.7	Hufford Michael K & Sherri L	Hufford Michael K & Sherri L	Easement	Survivor	Book 2125 / Page 1110		8/25/2017	4825 SPRINGFIELD-JAMESTOWN RD; SPRINGFIELD 45502
32	AE-H	100-12-00036-000-035	1.85	Leece Cody J & Ashley M Bisel	Hufford Michael K & Sherri L	Easement	Survivor	Book 2136 / Page 15		12/28/2017	4891 SPRINGFIELD-JAMESTOWN RD; SPRINGFIELD 45502
33	Lot 16	100-11-00011-304-001	25	LLH MRS MASTER RE LLC	Millard Refrigerated Services Inc			Limited Warranty	Book 2024 / Page 2439	4/23/2014	
34	NA	100-11-00005-000-007	0.75	Morgan Charles D & R Brian Co Trustees	Morgan Robert R			Certificate of Transfer	Book 1597 / Page 1049	4/14/2003	W. Blee Rd
35	N/A	100-11-00005-000-010	78.85	Morgan Charles D & R Brian Co Trustees	Morgan Robert R			Certificate of Transfer	Book 1597 / Page 1050	4/14/2003	Blee Rd
36	AE-H	100-12-00036-000-064	6.05	Odum Jack B & Linda L with easement for Avigation	Thomas H. Lagos & Martina K. Lagos			Warranty; Avigation Easement referenced	Book 1473 / Page 697	5/25/2001	Sparrow Rd
37	N/A	100-11-00010-000-031	12.03	Rogers Carl C & Evelyn	Rex A Johnson and Kimberly S. Johnson			Survivor	Book 859 / Page 219	5/16/1990	Jackson Rd
38	N/A	100-11-00006-301-021	18.06	Saks Nancy K & Daniel Trustees	William A Crist			Warranty	Book 1900 / Page 107 (deed covers a "one-sixth interest")	4/8/2010	4902 Peacock Rd
39	AE-F	100-11-00010-000-014	0.5	McEldowney Tamera Sue	Talbert Michael E (Seller)	Existing Easement; Future Simple Fee	Future RPZ Land Clearing	Previous deed was a Special Warranty Deed (10/3/2007); 2019 deed unavailable	10/3/2007 deed is in Book 1831 / Page 1124	5/6/2019	2116 W JACKSON RD; YELLOW SPRINGS 45387
40	Lot 3	100-11-00011-302-005	7.95	TLA Real Estate Holdings LLC	City of Springfield Ohio			Municipal Quit Claim	Book 2134 / Page 1587	12/12/2017	LOT 13; Re-plat Airpark Ohio Plat Sec 1
41	AE-C	100-11-00004-000-012	54.78	Wright Roger W	Cincinnati Capital Partners 264 LLC	Existing Easement; Future Simple Fee	Future RPZ Land Clearing; Relocate Jackson Rd.	Warranty	Book 2144 / Page 642	5/11/2018	7220 TANYARD RD REAR; YELLOW SPRINGS 45387
42	N/A	100-11-00006-000-022	106.7	Young Ruth Y	Young Herbert A. Trust/Security National Bank			Fiduciary	Book 2044 / Page 870	12/18/2014	Sparrow Rd
43	AE-A	100-11-00004-000-006	75.48	Waddle, Steven E & Thomas J	Waddle, Steven E & Thomas J	Existing Easement; Future Simple Fee	Future RPZ Land Clearing; Relocate Jackson Rd.	Affidavit of Title (inheritance)	Book 2052/page2558	4/16/2015	6736 Tanyard Rd. Federal project 9-33-020-801
44	N/A	100-11-00004-000-011	0.70	Shaw Audrey C	Shaw Leroy S					1/3/2001	6715 Tanyard Rd
45	N/A	100-11-00011-000-019	1.16	Black, Linda L Trustee	PHILIPS, Philemon L & Maria T	Future Fee Simple	Future RPZ Land Clearing	Quit claim	Book 1901/ Page 2209	5/3/2010	1816 W Blee Rd
46	N/A	100-11-0011-000-004	1.36	Black, Linda L Trustee	PHILIPS, Philemon L & Maria T			Quit claim	Book 1901/ Page 2209	5/3/2010	Blee Rd
47	N/A	100-11-0011-000-015	13.39	Timmons, Larry E Jr & Regina L	Nancy J Folck	Future Fee Simple	Future RPZ Land Clearing	Warranty	Book 2054/ Page 1839	5/5/2015	Blee Rd
48	N/A	100-11-0011-000-021	x	Goodbar, Jeffrey A		Future Fee Simple	Future RPZ Land Clearing				
49	N/A	100-11-0011-102-025	3.04	Goodbar, Jeffrey A & Sandra A	Timothy B & Denise A. Folk	Future Fee Simple	Future RPZ Land Clearing			8/6/2009	2020 W. Blee Rd
50	N/A	100-11-00011-301-016	15.26	Folk, Blair E & Nancy J Co Trustees	Folk, Blair E & Nancy J	Future Fee Simple	Future RPZ Land Clearing			12/27/1994	2037 W. Blee Rd

LAND INTEREST TABLE CONTINUED ON SHEET EX3

LAND INTEREST TABLE LEGEND	
	Existing Airport Property (Fee Simple or Easement)
	Existing City of Springfield Land (Released from the FAA)
	Existing City of Springfield Land (Not Federally Obligated)
	Existing Airport Owned Land in Easement; Future Fee Simple Acquisition
	Future Airport Fee Simple Land Acquisition

**FINAL DRAFT**

333 North Alabama Street  
Suite 200  
Indianapolis, IN 46204  
317.299.7500  
FAX: 317.291.5605

**WOOLPERT**  
ARCHITECTURAL ENGINEERING

CERTIFIED BY: _____	DESIGN ENGINEER: _____	DATE: _____
DESIGNED BY: GCF	DRAWN BY: RLS	
CHECKED BY: MJM	APPROVED BY: CJS	

No.	DATE	REVISION

**AIRPORT LAYOUT PLAN**  
**AIRPORT PROPERTY INVENTORY MAPS**  
**EXHIBIT "A"**  
**SPRINGFIELD-BECKLEY MUNICIPAL AIRPORT SPRINGFIELD, OHIO**

PROJECT No: 076515  
DATE: 03-09-2020  
AIP No: 3-39-0072-024-2016  
HORIZ. SCALE:  
VERT. SCALE:  
SHEET NO.

PRELIM EX2

Layout Tab Name: EX3 AIRPORT PROPERTY INVENTORY MAPS, Images: SGH\_OH\_from sid 04 gray-scale.tif, Xrefs: 76515-TBLX.dwg, 76515-X.dwg, 76515-P.dwg, 76515-proposed-air-space.dwg, SGH\_Fee\_CCI.dwg, SGH\_Easmts\_CCI.dwg, SGH\_SURVEY\_Point.dwg  
 Last Saved By: Firrie, 3/9/2020 7:21:15 AM  
 C:\DC\clients\Springfield-Beckley Municipal Airport OH (SGH)\76515 SGH Master Plan\Cadd\Exhibit A\76515 Exhibit A\_gpl.dwg Plotted By: Firrie, Gaster Plotted: March 9, 2020, 7:21:52 AM

SPRINGFIELD BECKLEY MUNICIPAL AIRPORT (SGH) LAND INTEREST TABLE (CONTINUED)											
TRACT #	PREVIOUS MAP ID#	PARCEL #	ACRES	OWNER	SELLER	ACQUISITION TYPE	NOTES AND PROJECT TYPE	INSTRUMENT	RECORDER LIBER	TRANSFER DATE	ADDRESS/DESCRIPTION
51	N/A	100-11-00010-300-015	0.29	Shattuck, James E & Barbara							2409 W Jackson Rd
52	N/A	100-11-00010-300-016	0.36	Speakman, Scott D	Speakman, Scott D & Carol E					1/11/2017	2395 W Jackson Rd
53	N/A	100-11-00010-300-017	0.62	Schwer, Cynthia D	Digel, Matthew J					8/9/2006	2383 W Jackson Rd
54	N/A	100-11-00010-300-018	0.62	Wood, James D & Vergie M							2367 W Jackson Rd
55	N/A	100-11-00010-300-019	0.62	Clorich, Russel G	Bonnie L Smith					3/30/1994	2349 W Jackson Rd
56	N/A	100-11-00010-300-020	0.63	Bittner, Donald E	Bittner, Donald E & Cynthia E			Quit Claim	Book 671/Page 97	9/24/1996	2338 W Jackson Rd
57	N/A	100-11-00010-300-023	3.20	Donnaker, Frank E & Brenda J	Bayview Loan Servicing LLC					5/9/2014	2311 W Jackson Rd
58	N/A	100-11-00010-300-082	17.14	Hirtzinger, Matt W & Kristi L	Dinmen, Paul W Trustee					1/19/2011	2275 W Jackson Rd
59	N/A	100-11-00010-300-081	1.37	Hoyt, Ronald W & Toni A	Zimmer, John Michael					10/27/2015	2237 W Jackson Rd
60	N/A	100-11-00010-300-084	0.97	Stelter, LLC	Stelter Investments/Harrold, Joseph W & April D					5/24/2006	2215 W Jackson Rd
61	N/A	100-11-00010-300-027	0.64	Van Zant, Jeffrey A & Connie L	Van Zant, Connie L					3/20/2008	2197 W Jackson Rd
62	N/A	100-11-00010-300-028	0.63	Donnaker, Franklin E	Donnaker, Franklin E & Marilyn S					11/15/2007	2175 W Jackson Rd
63	N/A	100-11-00010-300-029	0.63	Wilson Wayne & Patricia	Johnson, Stephen & Irene J Duffy					8/27/2019	2163 W Jackson Rd
64	AE-F	100-11-00010-300-030	1.00	Wilson Wayne & Patricia	Johnson, Stephen & Irene J Duffy	Easement				8/27/2019	W Jackson Rd
65	AE-F	100-11-00010-300-031	20.75	Garrety Charles W	Irene Gundolf	Existing Easement; Future Simple Fee	Future RPZ Land Clearing			9/14/1990	2087 W Jackson Rd
66	AE-E	100-11-00010-000-021	49.82	Svensden Ellen G & Charles W Garrety	Svensden, Ellen G	Existing Easement; Future Simple Fee	Future RPZ Land Clearing	Warranty	Book 1412/Page 1542	2/10/1997	1969 W Jackson Rd
67	N/A	100-11-00004-000-004	15.99	Garrety Charles W	Shaw Leroy S & Audrey C			Certificate of Transfer (inheritance)	Book 382 Page 343	11/10/1999	Tamyard Rd
68	AE-B	100-11-00004-000-007	39.41	George E Alig	George E Alig	Existing Easement; Future Simple Fee	Future RPZ Land Clearing			3/14/1995	725 W Jackson Rd. Federal project 9-33-020-801
69	AE-C	100-11-00004-000-013	5.22	Shaw, J Russell	Shaw, J Russell & Kathryn E	Existing Easement; Future Simple Fee	Future RPZ Land Clearing			7/1/1993	887 W Jackson Rd
70	N/A	100-12-00035-000-036	163.55	A&T Farm LLC	Thompson, R Alan & Theresa L					10/27/2017	5785 Springfield-Jamestown Rd
71	Lot 3	100-11-00011-302-008	12.00	Meva Formwork Systems, Inc	City of Springfield			Plat		9/15/2009	200 Airpark Dr. Lots 11 & 12 of Airpark Re-Plat Section 1
72	AE-H	100-12-00036-000-036	28.49	Odum, Jack B & Linda L	Lagos, Thomas H	Existing Easement; Future Simple Fee	Future RPZ Land Clearing			5/25/2001	W Sparrow Rd
73	N/A	100-11-00011-102-012	1.82	Preston, Hearold F	Folk, Co Trustees					8/29/2012	2040 W Blee Rd
74	AE-H	100-12-00036-000-052	5.10	Davis, Jimmie J & Louise E	Lagos, Matina K	Easement				6/11/2001	4719 Springfield-Jamestown Rd
75	AE-H	100-12-00036-000-053	5.07	Wooten, Tara Smith	Lagos, Matina K	Easement				6/16/1999	Springfield-Jamestown Rd
76	AE-H	100-12-00036-000-054	5.04	Wooten, Tara Smith	Lagos, Matina K	Easement				6/16/1999	4675 Springfield-Jamestown Rd
77	AE-H	100-12-00036-000-046	2.00	Ayers, Brant		Easement				9/22/1995	364 W Sparrow Rd
78	AE-H	100-12-00036-000-039	1.11	Lahman, Jerry L	Vaughn, Christopher & Charla	Easement				7/14/2004	376 W Sparrow Rd
79	AE-H	100-12-00036-000-038	1.11	Dingledine, Todd E & Tracy A		Easement				Not Avail	388 W Sparrow Rd
80	AE-H	100-12-00036-000-062	1.89	Gerhardt, Paul D & Ginger L		Easement				7/14/1997	400 W Sparrow Rd
81	AE-H	100-12-00036-000-018	1.50	Cunningham, Bradley S & Aimee L	Eubanks, Thomas S	Easement				3/1/1999	428 W Sparrow Rd
82	AE-D or AE-H	100-12-00036-000-017	1.00	Weaver, Wayne E & Tamara	Weaver, Wayne E & Tamara	Easement				9/10/1997	W Sparrow Rd
83	AE-D	100-12-00036-000-016	1.00	Weaver, Wayne E & Tamara	Weaver, Wayne E & Tamara	Easement				9/10/1997	440 W Sparrow Rd
84	AE-D	100-12-00036-000-015	2.00	King, William E	King, Ruth E	Easement				3/15/2017	472 W Sparrow Rd

LAND INTEREST TABLE LEGEND	
	Existing Airport Property (Fee Simple or Easement)
	Existing City of Springfield Land (Released from the FAA)
	Existing City of Springfield Land (Not Federally Obligated)
	Existing Airport Owned Land in Easement; Future Fee Simple Acquisition
	Future Airport Fee Simple Land Acquisition

**PREVIOUS LAND INTEREST TABLE INFORMATION ON SHEET EX2**

AIR NATIONAL GUARD (ANG) LEASE SCHEDULE		
DESCRIPTION	DATE	ACRES
DA-46-022-ENG-2053	5-Apr-1954	41.4
Supplement Agreement Modification #1	20-Mar-1956	N/A (no change to area)
Supplement Agreement Modification #2	1-Mar-1958	N/A (no change to area)
Supplement Agreement Modification #2	1-Mar-1958	10.51 (added)
Supplement Agreement Modification #2	1-Mar-1958	0.81 (added)
Supplement Agreement Modification #2	1-Mar-1958	0.32 (added)
Supplement Agreement Modification #3	15-Feb-1963	N/A (no change to area)
Supplement Agreement Modification #4	4-Dec-1964	0.04 (added)
License Agreement for DA-46-022-ENG-2053	1-Feb-1966	N/A (no change to area)
Supplement Agreement Modification #5	20-Sep-1968	6.1 (added)
Supplement Agreement Modification #5	20-Sep-1968	17.0 (added)
Supplement Agreement Modification #5	20-Sep-1968	2.8 (added)
Supplement Agreement Modification #5	20-Sep-1968	0.28 (added)
Supplement Agreement Modification #6	3-May-1972	2.80 (revised*)
Supplement Agreement Modification #6	3-May-1972	6.1 (revised*)
Supplement Agreement Modification #6	3-May-1972	17.0 (revised*)
Supplement Agreement Modification #6	3-May-1972	2.82 (revised*)
Supplement Agreement Modification #7	6-Jun-1975	1.13 (removed from lease)
Supplement Agreement Modification #7	6-Jun-1975	0.4/0.413 (added)
Supplement Agreement Modification #8	23-Dec-1976	32.7 (added)
Supplement Agreement Modification #9	3-Oct-1986	0.148 (added)
Supplement Agreement Modification #10	14-Jun-1989	N/A (time extension only)
Supplement Agreement Modification #11	6-Mar-2003	11.05 (added)
Supplement Agreement Modification #11	6-Mar-2003	4.6 (added)
Supplement Agreement Modification #12	31-Aug-2004	2.0 (added)
Supplement Agreement Modification #13	11-Jan-2011	22.81 (added)
Supplement Agreement Modification #14	17-Sep-2018	2.0 (removed from lease)

\* Parcel descriptions in Mod # 5 were corrected in Mod #6

<b>FINAL</b>	DESIGNED BY: GCF	DRAWN BY: GCF	DATE:
	CHECKED BY: M.M	APPROVED BY: CJS	
<b>DRAFT</b>			
333 North Alabama Street Suite 200 Indianapolis, IN 46204 317.299.7500 FAX: 317.291.5605 <b>WOOLPERT</b> ARCHITECTURAL ENGINEERING CONSULTANTS			
REVISION	DATE		
No.			
AIRPORT LAYOUT PLAN AIRPORT PROPERTY INVENTORY MAPS EXHIBIT "A" SPRINGFIELD-BECKLEY MUNICIPAL AIRPORT SPRINGFIELD, OHIO			
PROJECT No: 076515			
DATE: 03-09-2020			
AIP No: 3-39-0072-024-2016			
HORIZ. SCALE:			
VERT. SCALE:			
SHEET NO.			

PRELIM EX3