

Layout Tab Name: 9; Images: 150-5300-13a-chn1-interactive-201612-77.jpg; 150-5300-13a-chn1-interactive-201612-80.jpg; SGH\_OH\_from sid 04\_grayscale.tif; Xrefs: 76515-TBLK.dwg; SGH Additional Runway Points.dwg; 76515-X.dwg; SGH EOR Points.dwg; SGH PARCEL LINES.dwg; 76515-proposed airspace.dwg; SGH existing airspace.dwg  
 Last Saved By: Frie, 9/13/2021 1:01:26 PM  
 C:\D:\Clients\Springfield-Beckley Municipal Airport OH (SGH)\76515 SGH Master Plan\Cadd\Cad\76515 PP RW 15-33.dwg Plotted By: Frie, Gaster Plotted: September 13, 2021, 1:15:18 PM

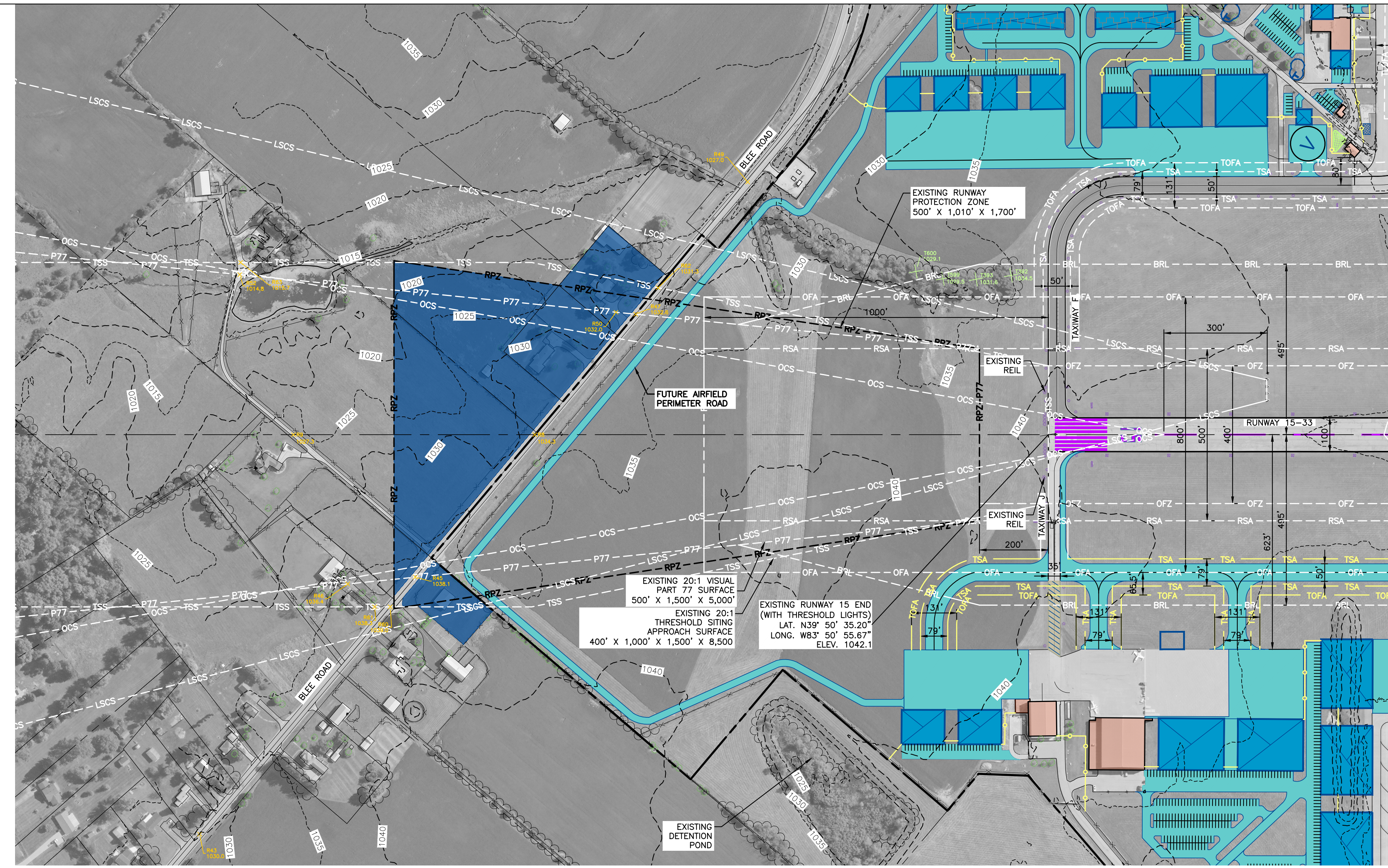

MAGNETIC DECLINATION  
 2018 = 6° 26' W ± 0" 22"  
 CHANGING BY 0" 3" W PER YEAR  
 SOURCE DOCUMENT IS NATIONAL  
 GEOPHYSICAL DATA CENTER - NOAA  
 SATELLITE AND INFORMATION CENTER.  
 IMAGE DATE: FEBRUARY 2018

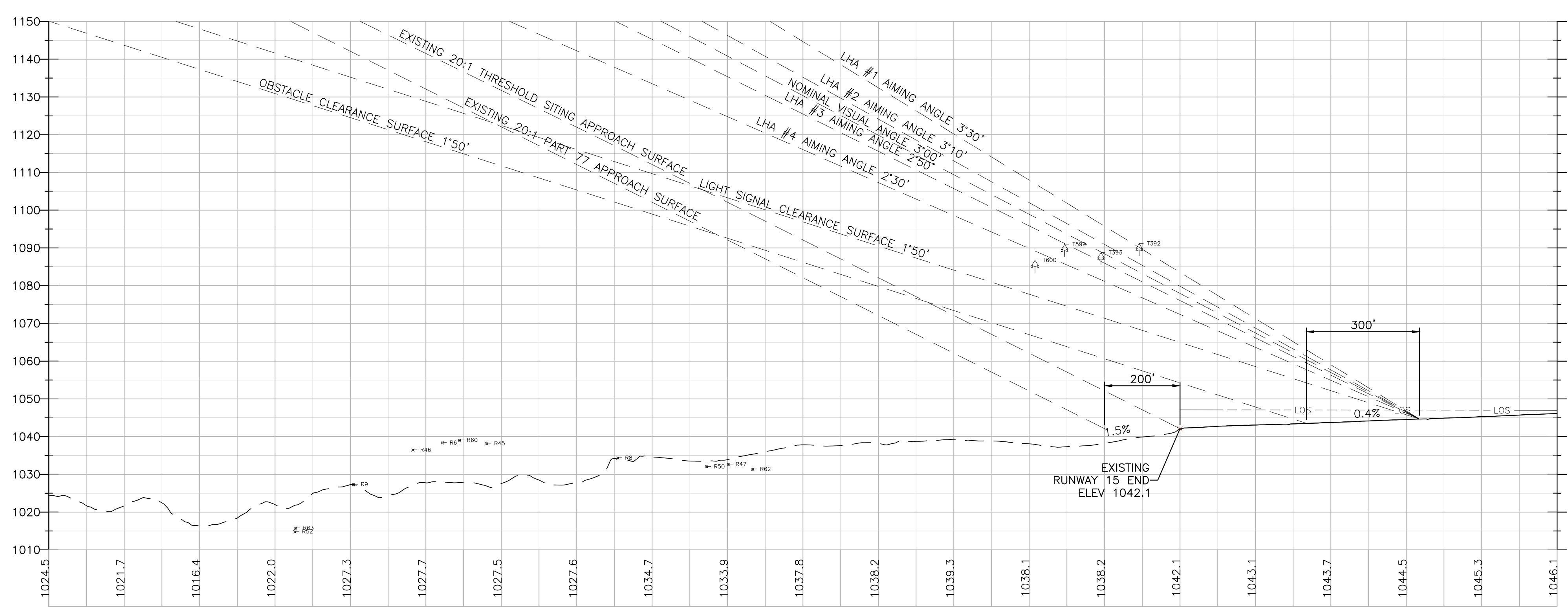
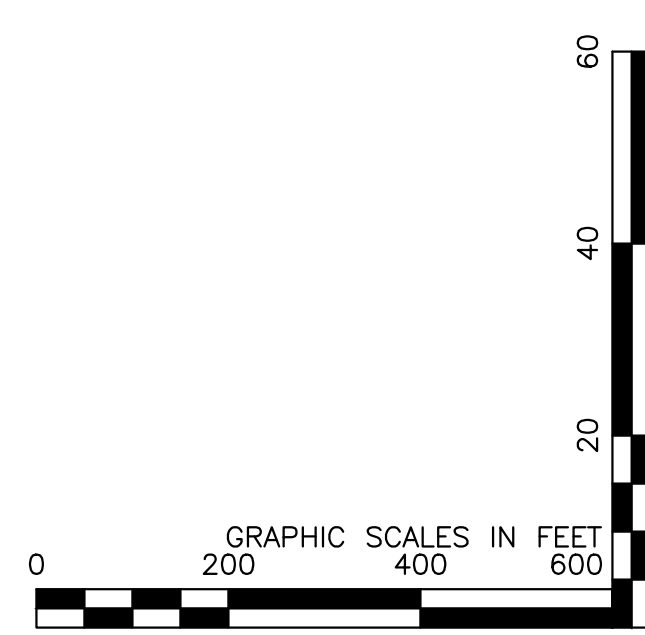

NOTE: SEE SHEET 8 FOR OBSTRUCTION TABLES

LEGEND: SYMBOLS		
EXISTING	FUTURE	FACILITY
[Symbol]	[Symbol]	BUILDING
[Symbol]	[Symbol]	AIR NATIONAL GUARD BASE LIMITS
[Symbol]	[Symbol]	AVIGATIONAL EASEMENTS
[Symbol]	[Symbol]	AIR NATIONAL GUARD BASE TRANSFERRED TO AIRPORT
[Symbol]	[Symbol]	LAND ACQUISITION
[Symbol]	[Symbol]	ROAD ELEVATION
[Symbol]	[Symbol]	TREE OBSTACLE ELEVATION
[Symbol]	[Symbol]	POLE OBSTACLE ELEVATION
[Symbol]	[Symbol]	BUILDING OBSTACLE ELEVATION
[Symbol]	[Symbol]	TOWER OBSTACLE ELEVATION
[Symbol]	[Symbol]	MED INTENSITY RUNWAY EDGE LIGHT
[Symbol]	[Symbol]	MED INTENSITY RUNWAY THRESHOLD LIGHT
[Symbol]	[Symbol]	REL
[Symbol]	[Symbol]	MED INTENSITY TAXIWAY LIGHT
[Symbol]	[Symbol]	MALS/R LIGHTING SYSTEM
[Symbol]	[Symbol]	PAPI/VASI
[Symbol]	[Symbol]	GUIDANCE SIGN
[Symbol]	[Symbol]	WINDCONE
[Symbol]	[Symbol]	AWOS/BEACON/GLIDESLOPE
[Symbol]	[Symbol]	AIRPORT REFERENCE POINT
[Symbol]	[Symbol]	AIRCRAFT TIE DOWN
[Symbol]	[Symbol]	TREE

LEGEND: LINETYPE		
EXISTING	FUTURE	FACILITY
[Linetype]	[Linetype]	AIRPORT PROPERTY LINE
[Linetype]	[Linetype]	PARCEL LINE
[Linetype]	[Linetype]	RUNWAY/TAXIWAY CENTERLINE
[Linetype]	[Linetype]	CONTOURS
[Linetype]	[Linetype]	EDGE OF PAVEMENT (PAVEMENT AREA)
[Linetype]	[Linetype]	FENCE LINE
[Linetype]	[Linetype]	CFR PART 77 SURFACES
[Linetype]	[Linetype]	THRESHOLD SITING APPROACH SURFACES
[Linetype]	[Linetype]	DEPARTURE SURFACES
[Linetype]	[Linetype]	GLIDESLOPE QUALIFICATION SURFACE
[Linetype]	[Linetype]	RUNWAY PROTECTION ZONE
[Linetype]	[Linetype]	RUNWAY SAFETY AREA
[Linetype]	[Linetype]	RUNWAY OBJECT FREE AREA
[Linetype]	[Linetype]	RUNWAY OBSTACLE FREE ZONE
[Linetype]	[Linetype]	RUNWAY PRECISION OBSTACLE FREE ZONE
[Linetype]	[Linetype]	RUNWAY VISIBILITY ZONE
[Linetype]	[Linetype]	TAXIWAY SAFETY AREA
[Linetype]	[Linetype]	TAXIWAY OBJECT FREE AREA
[Linetype]	[Linetype]	TAXILANE OBJECT FREE AREA
[Linetype]	[Linetype]	AWOS CRITICAL AREA (30' HEIGHT CLEARANCE)
[Linetype]	[Linetype]	35' BUILDING RESTRICTION LINE
[Linetype]	[Linetype]	ILS CRITICAL AREA
[Linetype]	[Linetype]	INNER APPROACH OBSTACLE FREE ZONE
[Linetype]	[Linetype]	LIGHT SIGNAL CLEARANCE SURFACE
[Linetype]	[Linetype]	OBSTACLE CLEARANCE SURFACE
[Linetype]	[Linetype]	LINE OF SIGHT

- GENERAL NOTES**
- ALP REFLECTS AIRPORT DESIGN STANDARDS PER FAA ADVISORY CIRCULAR 150/5000-13A, CHANGE #1, ALP PREPARED IN ACCORDANCE WITH FAA ALP CHECKLIST (SOP 2.00) DATED OCTOBER 1, 2013. REFERENCE ALP DATA SHEET FOR APPLICATION TO DESIGN STANDARDS, SURVEYED INFORMATION, SOURCE OF BASE MAPPINGS, AND SUPPORTING ALP DATA.
  - SEE ALP DATA SHEET FOR REFERENCE TO SUPPORTING ALP DATA. SEE TERMINAL AREA DRAWINGS FOR BUILDING/STRUCTURE DATA.
  - ALL ELEVATIONS EXPRESSED IN MEAN SEA LEVEL (MSL), UNLESS OTHERWISE NOTED. ROADWAY ELEVATIONS REFLECT GROUND SURFACE ELEVATION. TRAVERSEWAY ELEVATIONS AT ROAD CENTERLINES ARE DISPLAYED AT THEIR ACTUAL SURFACE ELEVATION.
  - RESTRICTION AREAS: BUILDING RESTRICTION LINE (BRL) ESTABLISHED TO PROVIDE 35' OBSTACLE CLEARANCE BASED ON PART 77 MAGNARY SURFACES AND THE AWOS-3 PROTECTION AREA. DEVELOPMENT LIMITED TO 15' BELOW THE WIND SENSOR ELEVATION WITHIN A 500' RADIUS OF THE AWOS, AND LIMITED TO 10' ABOVE THE WIND SENSOR ELEVATION BETWEEN A 500' TO 1,000' RADIUS.
  - AIRFIELD PERIMETER FENCE IS TYPICALLY 10' TALL. FENCE FENCING TO MEET FAA/TSA STANDARDS OR WILDLIFE REQUIREMENTS.
  - (\*) INNER WIDTH OF PART 77 APPROACH TO MATCH PRIMARY SURFACE PER FAA ORDER JO 7400.2K, CHANGE 1 (DATED 7-24-2014).
  - THE BUILDINGS, POLES AND TREE OBSTACLES INDICATED IN PLAN VIEWS ARE ALSO ACTUAL OR POTENTIAL PENETRATIONS/OBSTRUCTIONS TO AT LEAST ONE OF THE SURFACES DISPLAYED WITHIN THE SHEET. REFER TO RUNWAY OBSTRUCTION TABLE SHEET FOR DETAILS.

<b>CERTIFIED BY:</b> DESIGN ENGINEER DATE <b>DESIGNED BY:</b> GCF <b>CHECKED BY:</b> MJM <b>APPROVED BY:</b> CJS	333 North Alabama Street Suite 200 Indianapolis, IN 46204 317.299.7500 FAX: 317.291.5605		<b>PROJECT No:</b> 076515 <b>DATE:</b> 03-09-2020 <b>AIP No:</b> 3-39-0072-024-2016 <b>HORIZ. SCALE:</b> <b>VERT. SCALE:</b>	<b>AIRPORT LAYOUT PLAN</b> <b>RUNWAY 15 END EXISTING AND FUTURE APPROACHES</b> <b>SPRINGFIELD-BECKLEY MUNICIPAL AIRPORT SPRINGFIELD, OHIO</b>			
					<b>No.</b>	<b>DATE</b>	<b>REVISION</b>
					<div style="text-align: right; font-size: 2em; font-weight: bold;">9</div>		